



Dairy Dispenser Product # SK-1

The Silver King Dairy Dispenser is the newest innovation in dispensing technology. Featuring a patented load cell, cream is constantly weighed for accurate dispensing every time. No need to press a “Refill” button EVER AGAIN.

The patented valve has been simplified for fast bag changes, eliminating the risk of losing parts and simplified cleaning.

The patented valve and load cell are powered by the new and improved Silver King controller to provide accurately measured shots of creamer on each dispense.

A new capacitive touch control panel increases operational efficiency with recipe programming for hot, flavored, iced coffee, and a fourth menu item. There are no mechanical buttons that can wear out. The display panel shows how much product is remaining and when a bag needs to be replaced.

Product Features

- Patented load cell technology constantly measures how much product is in the hopper
- Simplified, patented valve makes bag changes fast and easy
- Simplified valve eases cleaning to a spray and wipe
- No risk of losing parts or reassembling incorrectly with a simplified valve design
- New capacitive touch control panel
- Recipe programmed for hot, flavored, and iced coffee with a fourth button for future menu growth
- Displays remaining product in hopper
- New and improved hopper makes creamer bag easier to load
- Same narrow footprint as the original SKMCD1P/C1 Creamer



A Marmon/Berkshire Hathaway Company

© 2018 Prince Castle LLC - Specifications and design are subject to change without notice

This product is patent protected. Patent information can be found at www.princecastle.com/patents/.



1600 Xenium Lane
Plymouth, MN 55441-3706

1-800-328-3329

www.silverking.com



Refrigerated Rail

Product # SKMCD-RR-5

Dimensions

Model Number	Width in (cm)	Height in (cm)	Depth in (cm)	Shipping Weight lbs (kg)	Shipping cu. ft. (cu. m.)
SK-1	9.62 (24.43)	29.03 (63.59)	16.61 (42.19)	70 (31.75)	4.98 (0.14)

Electrical

Model Number	Description	Volts	Hz	AMPS	Phase	Plug Number
SK-1	Dairy Dispenser	110-120	50/60	1.2	Single	NEMA 5-15P

Specifications

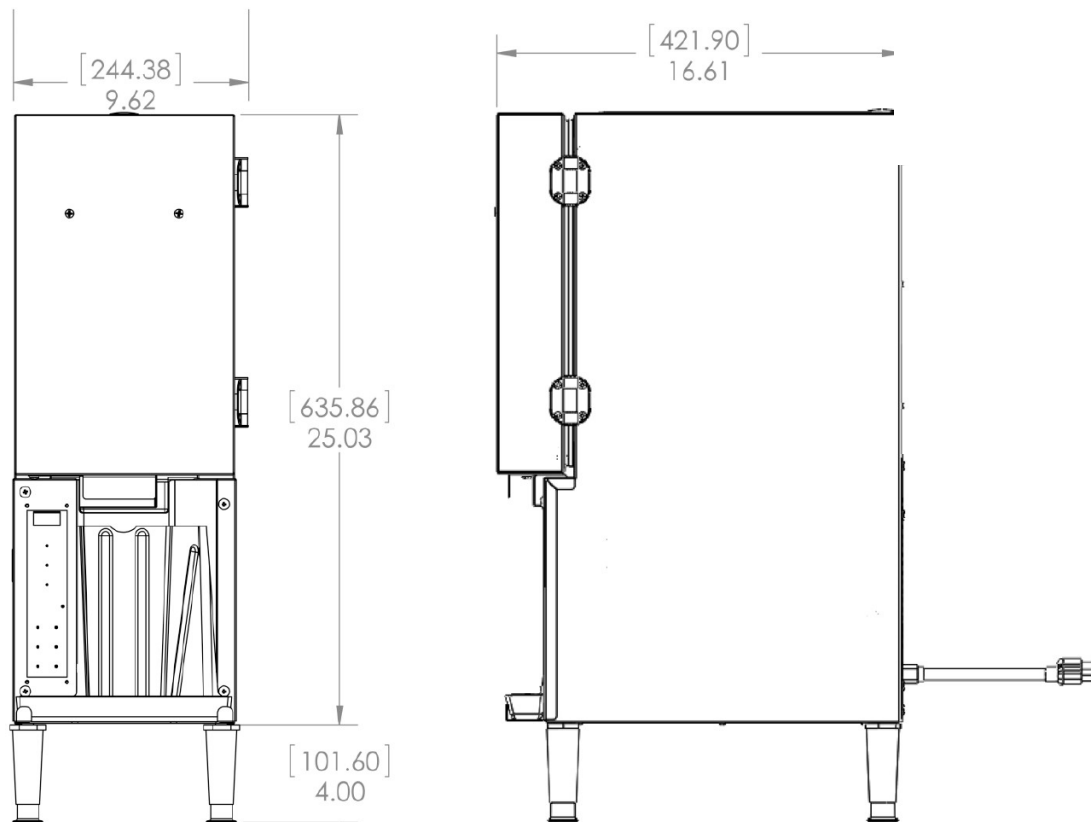

Certifications



MARMON A Marmon/Berkshire Hathaway Company

© 2018 Prince Castle LLC - Specifications and design are subject to change without notice
 This product is patent protected. Patent information can be found at www.princecastle.com/patents/.



1600 Xenium Lane
 Plymouth, MN 55441-3706

1-800-328-3329
www.silverking.com